

Operating MR CONFON Auditory System

Date: 25/11/2014

Written By: Adi

The system is composed of:

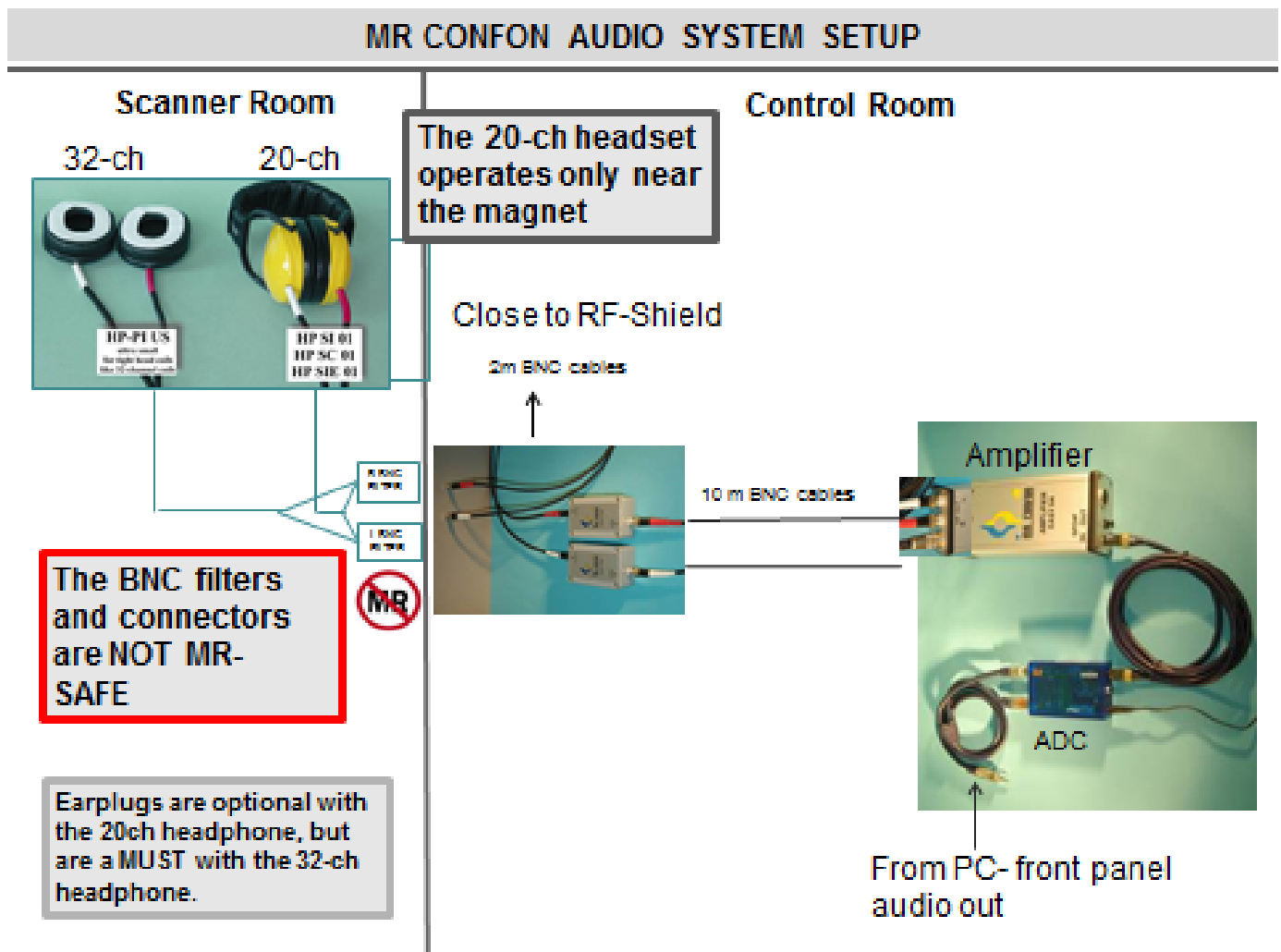

1. **Analog to Digital Converter-ADC** with input from the PC and output to the
2. **Amplifier** that is connected via ~2m BNC cables to a
3. **Transformer/Filter** that is connected via ~ 4m BNC cables to the
4. **BNC connectors on the RF panel in control room** that are connected on the other side to
5. **BNC filters on RF panel** that are connected via BNC adapter (splitter) to the
6. **Headphone**



We have two headphones, both are electrical:

1. electro-dynamic headphone (HP SC03)

2. piezo headphone (HP PI US02)

Headphone	Pictures	Coil	Passive dampening (at ~700 Hz, epi)	Passive dampening with earplugs	Earplugs	Comment
HP SC03		20-ch	up to 35 dB	> 55 dB	Optional	1. active in the presence of a magnetic field 2. Dedicated foam cushion 
HP PI US02		32-ch	15-18 dB with ear defender	~35 dB	Must	

The electro-dynamic headphone (HP SC03) and the piezo headphone (HP PI US02) can be connected in parallel via a BNC adapter mounted on the RF panel inside the magnet room.

Verify that only the chosen headphones are connected, and remember that the BNC filters and connectors are NOT MR-SAFE !!! So keep them away from the magnet.

If you're working with MR CONFON headphones - **Turn off** the sensimetrics amplifier.

Setting Up:

- Connect the audio cable to the **front** audio socket of the stimuli computer.
- A window of the sound driver will open, mark the *Speaker* checkbox (not Headphone).
- Check that the headphone of your choice is connected to the BNC filters inside the magnet room.
- Test the earphones.

Turning ON/OFF the system:

There is no ON/OFF switch bottom. Since the amplifier is getting warmed, unplug the system during the weekend.

Good Luck !

Adi